

# Free Local Area Trails Map

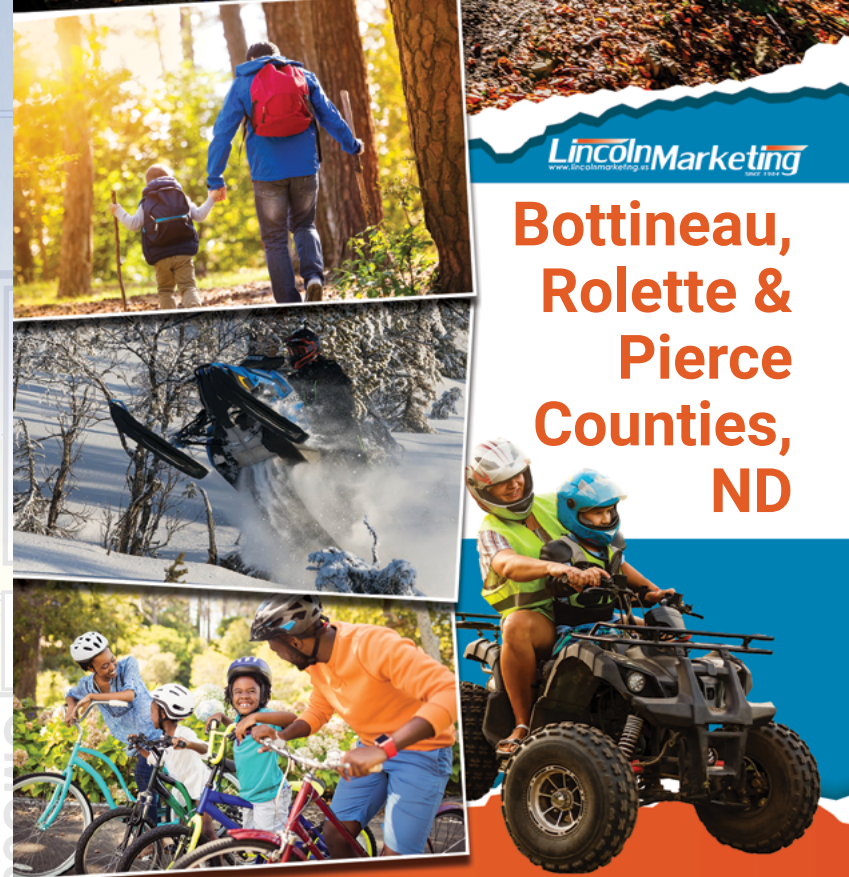

LincolnMarketing

**Bottineau, Rolette & Pierce Counties, ND**

Scan the QR Code for Digital Copy



Shop  
Dine  
Play  
Stay



# LOCALLY

...and support the community you live in!

# Bottineau County

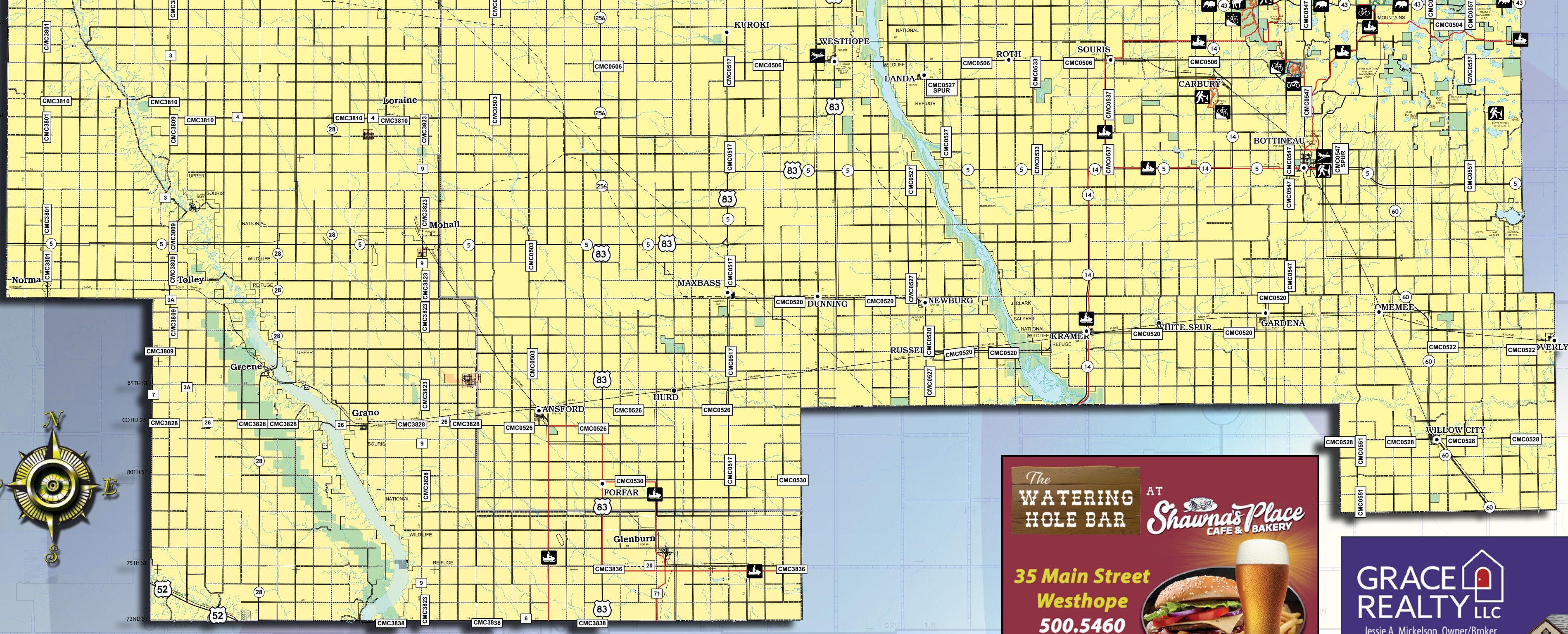

## Bottineau Lumber

Quality Building Products & Services

Lumber • Hardware  
Siding • Windows • Doors  
Paint • Custom Homes  
Farm & Ag Buildings

1074 Hwy. 5 NE  
Bottineau, ND

**(701) 228-3172**

Minnkota Windows Dealer

## BUCK'S PAVING

- Residential Paving
- Commercial Paving
- Sealcoating
- Driveways
- Parking Lots
- Seasonal Projects

Buck's Paving has set the standard of excellence in residential paving throughout Fargo, ND, Moorhead, MN, and the nearby areas. When you choose Buck's Paving, you can get your residential paving projects completed by a reputable and trusted residential asphalt paving contractor with years of experience. Count on our professionals to take care of asphalt pavement patching, asphalt driveway paving, driveway replacement, sidewalk work, and any other residential paving services.

723 3rd 1/2 Street S. - Breckenridge, MN 56520  
701-204-1587  
buckspaving1@gmail.com  
www.buckspaving.net

## Farmers Union Oil

WILLOW CITY, ND  
701-366-4371

PO BOX 68 • MAIN STREET  
WILLOW CITY, ND 58384  
Fax: 366-4577

**FULL-SERVICE STATION**

- 24-Hr Cardrol
- C-Store
- Chemicals
- Fertilizer
- Anhydrous
- Bulk Petroleum
- Seed Plant

CENEX

## The WATERING HOLE BAR

AT **Shawna's Place CAFE & BAKERY**

35 Main Street  
Westhope  
500.5460

**GAME ROOM • PARTY ROOM • CATERING**

## GRACE REALTY LLC

Jessie A. Mickelson, Owner/Broker

701-477-2204  
gracerealtyllc.com

201 1st Ave. SE  
Rolla, ND 58367

Hours:  
Mon - Thur 9am-4pm  
Also by appointment

## REDI - MIX CONCRETE

# ETA

## EVANS TRUCKING & AGGREGATE

Pricing and delivery contact David Evans-Dunseith, ND  
ph: 701-871-0077 • david.evans494@gmail.com  
concrete inquires: 701-871-3186

**ALSO AVAILABLE:**  
Crushed Gravel, Rip Rap, Pit Run, Washed Rock, Decorative Rock, Washed Sand, Clay and Fill, 1 1/2 Fractured Rock

## DEER HUNTING TIPS

- Wear Blaze Orange:** Being mistaken for a deer, can be deadly
- Scout the Area:** Before the hunting season begins, spend time scouting the hunting area. Look for deer signs such as tracks, droppings, rubs, and scrapes
- Practice Stealth and Scent Control:** Deer have an excellent sense of smell and can be easily spooked by human scent
- Know the Local Regulations and Laws:** Before you head out on your hunting trip, familiarize yourself with the local hunting regulations and laws.

Remember that ethical hunting practices, respect for wildlife, and safety should always be paramount while participating in any hunting activity. Additionally, always make sure to follow local hunting guidelines and regulations to protect the environment and wildlife populations. **HAPPY HUNTING!**

- Snowmobile Trail
- ORV Trail
- Hiking Trail
- Mountain Bike Trail
- Bike Trail
- Snowshoe Trail
- Nordic Ski Trail
- Equestrian Trail
- Scenic Byway
- Disc Golf Course
- Airport

Scan QR Code to go to the individual County Page

Bottineau County

This free publication is made possible by the advertisers and other local agencies and may not be reproduced. Please support the local advertisers on this publication. Comments and/or suggestions may be directed to: info@lincolnmktg.com

This map is prepared with information provided to us by others, therefore, Lincoln Marketing and the advertisers assume no liability in regards to trails (including accuracy). Please respect private property and no trespassing signs. Stay on trails. Exercise extreme caution on all lakes and streams. Obey all state and local laws and ordinances. Do not operate snowmobiles on county roads or state highways. Posted signs on the trails override the printed map trails.

View this publication online at [www.lincolnmktg.com](http://www.lincolnmktg.com)

## DACOTAH BANK

BANKING • INSURANCE • MORTGAGE • TRUST

# GO WITH INTEGRITY.

Local Decisions. Familiar Faces.

ROLLA | 15 E. Main  
BELCOURT | 4324 Highway 281  
dacotahbank.com

## HARRIS OIL & PROPANE

2 Locations / Open 24 hours

4471 Hwy. 281 Belcourt, ND 58316 701-477-6000  
9807 BIA Road 7 Belcourt, ND 58316 701-477-8500

Fresh-Made Pizza Available 24/7 - East Location  
Tax Free • Tobacco • Snacks  
Soda • Coffee • Cappuccino

**FULL SERVICE SHOP**  
Alignment • New/Wholesale Tires  
Repair • Oil Changes

Bulk Fuel • Gas • Diesel • Propane  
Tanks & New Tank set-Up Available  
Call us for your tanker/transport loads for all your gas & diesel needs!

## Sawmill Corner Stop

All your summer camping & winter fun supplies

10599 Lake Road  
Bottineau, ND 58318  
(Corner of Hwy. 43 & Lake Road)  
Phone: (701) 263-4325

- Coffee • Cappuccino • Bakery Items • Grocery • Health & Beauty
- Hot & Cold Food Including Breakfast & Home-Cooked Lunch Specials
- Outdoors • Household • Baby & Automotive Departments
- Self Serve Gas & Diesel 24 hrs a Day • Propane (Buy/Exchange)

## NAPOLEON + LIVESTOCK

Sale Every THURSDAY

Roger Sundsbak  
Cell: (701) 720-2603 • Phone: 701-754-2216

View current market report @  
[www.napoleonlivestock.com](http://www.napoleonlivestock.com)

The WATERING HOLE BAR AT **Shawna's Place CAFE & BAKERY**

35 Main Street Westhope 500.5460

GAME ROOM • PARTY ROOM • CATERING

**GRACE REALTY LLC**  
Jessie A. Mickelson, Owner/Broker

701-477-2204  
gracerealtyllc.com

Hours: Mon - Thur 9am-4pm  
Also by appointment

201 1st Ave. SE  
Rolla, ND 58367

**NAPOLEON + LIVESTOCK**

Sale Every THURSDAY

Roger Sundsbak  
Cell: (701) 720-2603 • Phone: 701-754-2216

View current market report @  
www.napoleonlivestock.com

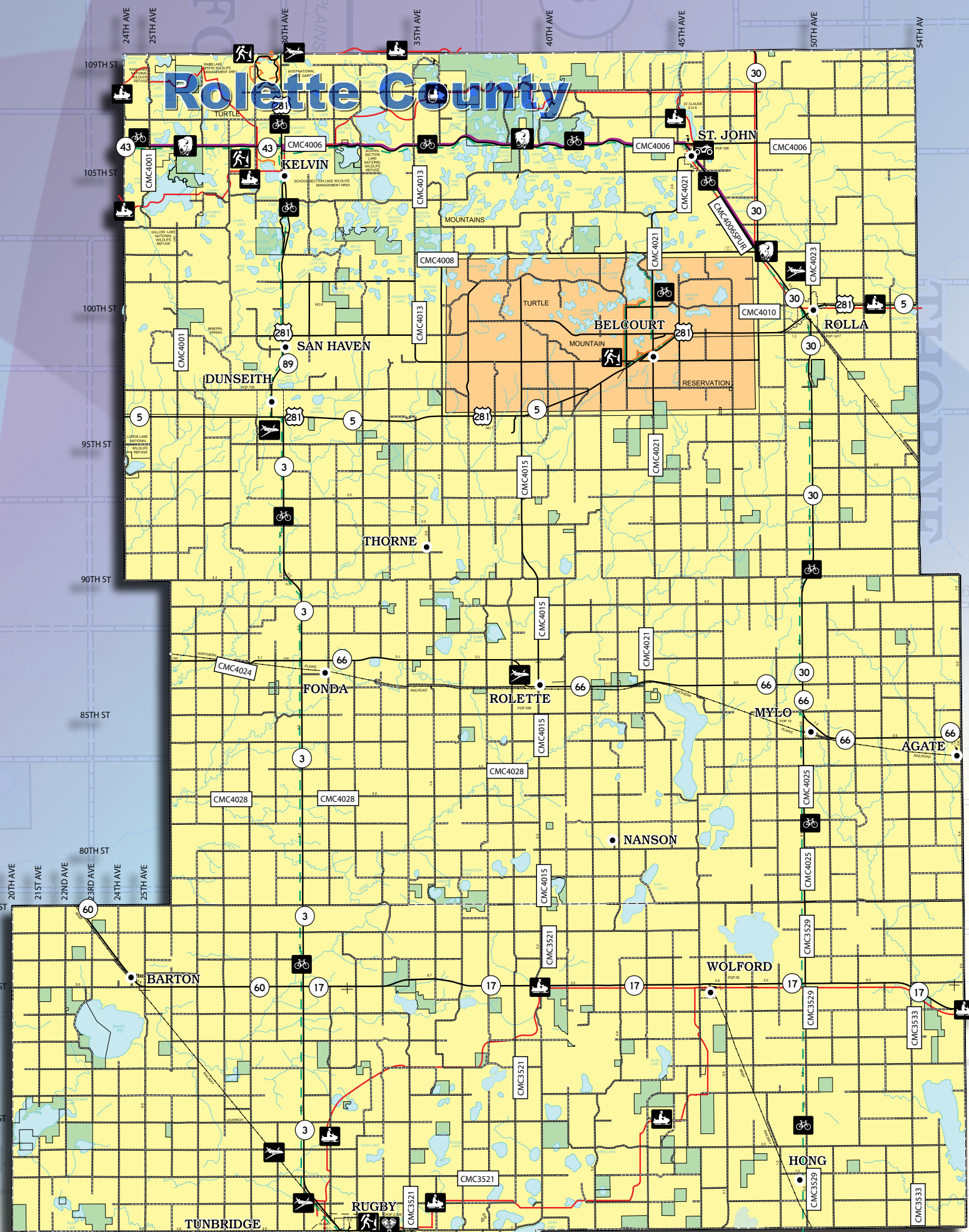

**Free Local Area Trails Map**

LincolnMarketing

**Bottineau, Rolette & Pierce Counties, ND**

**Sawmill Corner Stop**

All your summer camping & winter fun supplies

10599 Lake Road Bottineau, ND 58318  
Phone: (701) 263-4325

- Coffee • Cappuccino • Bakery Items • Grocery • Health & Beauty
- Hot & Cold Food Including Breakfast & Home-Cooked Lunch Specials
- Outdoors • Household • Baby & Automotive Departments
- Self Serve Gas & Diesel 24 hrs a Day • Propane (Buy/Exchange)

**REDI - MIX CONCRETE**

**ETA**

**EVANS TRUCKING & AGGREGATE**

Pricing and delivery contact David Evans-Dunseith, ND  
ph: 701-871-0077 • david.evans494@gmail.com  
concrete inquiries: 701-871-3186

ALSO AVAILABLE:  
Crushed Gravel, Rip Rap, Pit Run, Washed Rock, Decorative Rock, Washed Sand, Clay and Fill, 1 1/2 Fractured Rock

**Bottineau Lumber**

Quality Building Products & Services

Lumber • Hardware  
Siding • Windows • Doors  
Paint • Custom Homes  
Farm & Ag Buildings

1074 Hwy. 5 NE Bottineau, ND  
**(701) 228-3172**



Scan the QR Code for Digital Copy

**Farmers Union Oil**

FULL-SERVICE STATION

701-366-4371

- 24-Hr Cardrol
- C-Store
- Chemicals
- Fertilizer
- Anhydrous
- Bulk Petroleum
- Seed Plant

**BUCK'S PAVING**

- Residential Paving
- Commercial Paving
- Sealcoating
- Driveways
- Parking Lots
- Seasonal Projects

723 3rd 1/2 Street S. - Breckenridge, MN 56520  
701-204-1587  
buckspaving1@gmail.com  
www.buckspaving.net

**HARRIS OIL & PROPANE**

2 Locations / Open 24 hours

4471 Hwy. 281 Belcourt, ND 58316  
9807 BIA Road 7 Belcourt, ND 58316  
701-477-6000 701-477-8500

Fresh-Made Pizza Available 24/7 - East Location  
Tax Free • Tobacco • Snacks  
Soda • Coffee • Cappuccino

FULL SERVICE SHOP  
Alignment • New/Wholesale Tires  
Repair • Oil Changes

Bulk Fuel • Gas • Diesel • Propane  
Tanks & New Tank set-Up Available  
Call us for your tanker/transport loads  
for all your gas & diesel needs!

- Snowmobile Trail
- Hiking Trail/Route
- Bike Trail/Route
- Nordic Ski Trail
- Scenic Byway
- Mountain Bike Trail
- Snowshoe Trail
- ORV Trail
- Disc Golf Course
- Airport

Scan QR Code to go to the individual County Page

Rolette County  
Pierce County

This free publication is made possible by the advertisers and other local agencies and may not be reproduced. Please support the local advertisers on this publication. Comments and/or suggestions may be directed to: info@lincolnmktg.com

This map is prepared with information provided to us by others, therefore, Lincoln Marketing and the advertisers assume no liability in regards to trails (including accuracy). Please respect private property and no trespassing signs. Stay on trails. Exercise extreme caution on all lakes and streams. Obey all state and local laws and ordinances. Do not operate snowmobiles on county roads or state highways. Posted signs on the trails override the printed map trails.

View this publication online at [www.LincolnMarketing.us](http://www.LincolnMarketing.us)

**DACOTAH BANK**

BANKING • INSURANCE • MORTGAGE • TRUST

**GO WITH INTEGRITY.**

Local Decisions. Familiar Faces.

ROLLA | 15 E. Main  
BELCOURT | 4324 Highway 281  
dacotahbank.com

**YOUR Help is NEEDED!**

Do NOT Transport Invasive: Fish, Invertebrates, Aquatic Plants

**CLEAN. DRAIN. DISPOSE.**

KNOW THE LAWS YOU MAY NOT...  
• TRANSPORT WATERCRAFT WITHOUT REMOVING THE DRAIN PLUG.  
• ARRIVE AT LAKE ACCESS WITH DRAIN PLUG IN PLACE.  
• TRANSPORT AQUATIC PLANTS, ZEBRA MUSSELS, OR OTHER PROHIBITED SPECIES ON ANY ROADWAY.  
• LAUNCH A WATERCRAFT WITH PROHIBITED SPECIES ATTACHED.  
• TRANSPORT WATER FROM LAKES OR RIVERS.  
• RELEASE BAIT INTO THE WATER.

**GO GREEN**

Reduce, Reuse, Recycle

reduce waste, reuse materials & recycle properly

EVERY DAY IS EARTH DAY

Community/Home Gardens: Really good at absorbing carbon dioxide. Cuts down on pesticides/fertilizers. Also benefits mental health and provides fresh food.  
Composting: Decreases the amount of trash in landfills and reduces carbon emissions.  
Plant Trees: Planting trees is a classic Earth Day activity.  
Local Food: Buy local sustainable food.  
Clean-Up Events: Organize or participate in local clean-up efforts.  
Upcycle Crafts: Get creative by turning old items into new useful objects.

Cut back on single-use plastics, conserve water, drive less.

Advertisers Appreciate It!

Tell Them You Saw Them On The Map!

LincolnMarketing

Shop  
Dine  
Play  
Stay

**LOCALLY**

...and support the community you live in!